



How to use the Freka[®] Stoma Measuring Device

For selecting the length of a Freka[®] Belly Button ≥ 12 FR

Getting ready

- Always refer to local guidelines
- Collect all equipment needed on a clean table or tray
 - Freka[®] Stoma Measuring Device (Product code 7750921)
 - A 10ml luer slip syringe to remove water from current device
 - Non-sterile gloves
- Wash hands thoroughly with soap and water before and after carrying out this procedure
- Remove the patient's current device following manufacturer's instructions
- For mobile patients, the length of the stoma should be checked with the patient in a lying and sitting position



Instructions for use

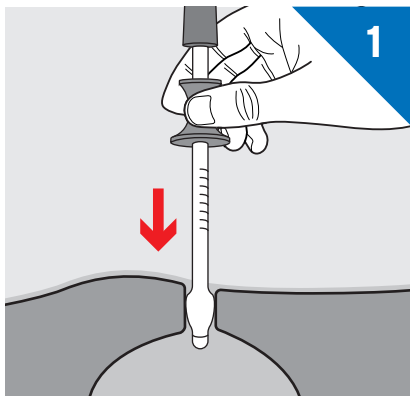

Insert the Stoma Measuring Device carefully through the stoma into the stomach.

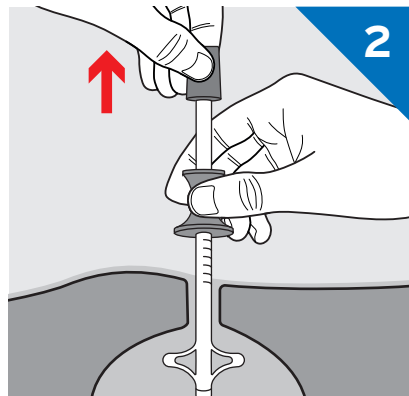

Pull the handle which will unfold a retention mechanism in the stomach.

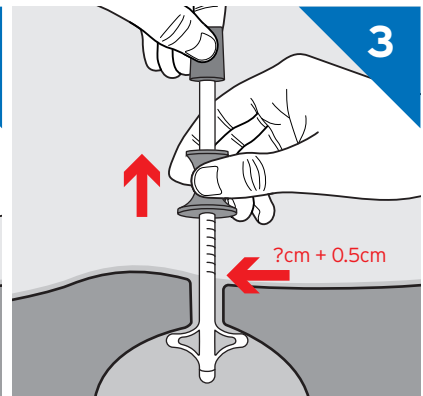

The Stoma Measuring Device is then withdrawn until slight resistance is felt. Now the stoma length can be read.

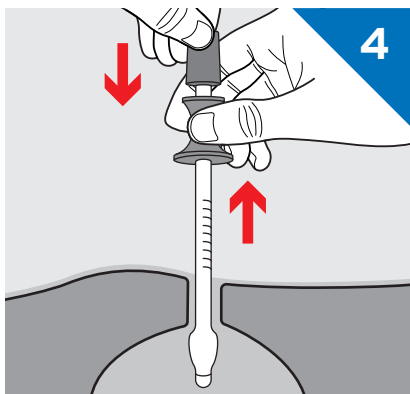

Push the handle back down to stretch the retention device. The Stoma Measuring Device can then be removed.

